

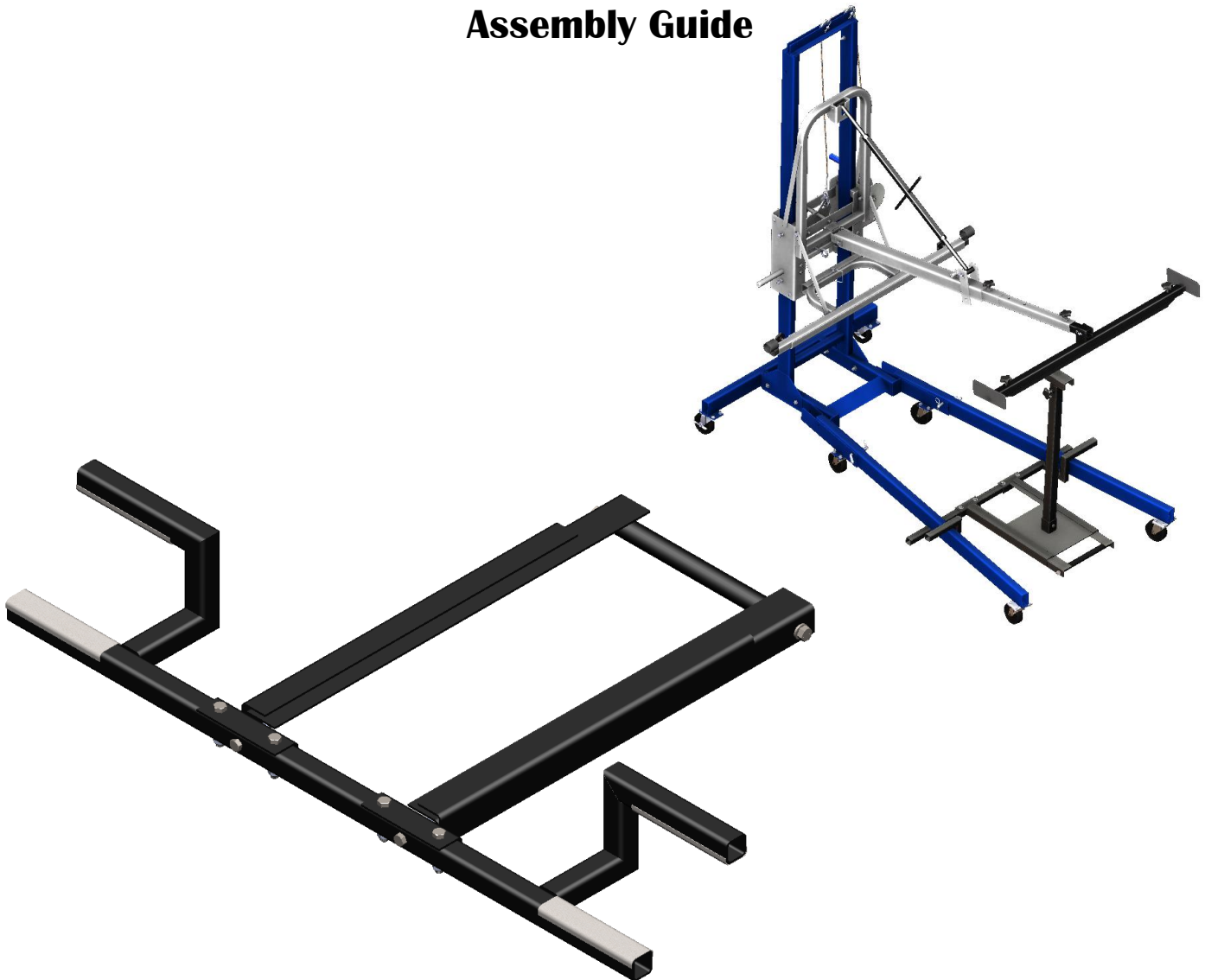

LK4051
STABILIZER CARRIAGE
Assembly Guide



www.prolinetoolsupply.com

(989) 315-8946

Table of Contents

STABILIZER CARRIAGE	3
SPECIFICATIONS	3
PARTS & HARDWARE	4
ASSEMBLY GUIDE	4
OPERATION	6

If you have any questions or comments, please call 1 (989) 315-8946.

Proline Tool & Supply, LLC
210 Pigeon Rd Bad Axe MI 48413 US
(989) 315-8946

Stabilizer Carriage

The LK4051 Stabilizer Carriage straddles the legs of the LK4000 Lift King (Main Component) and is designed for set up within seconds, without the need of pins or bolts. When the pickup box is on the lift, most shops use the LK4027 Stabilizer Bar while performing repairs. When the Stabilizer Bar is used in conjunction with the Stabilizer Carriage, the operator has the ability to move the pickup box around the shop.

Specifications

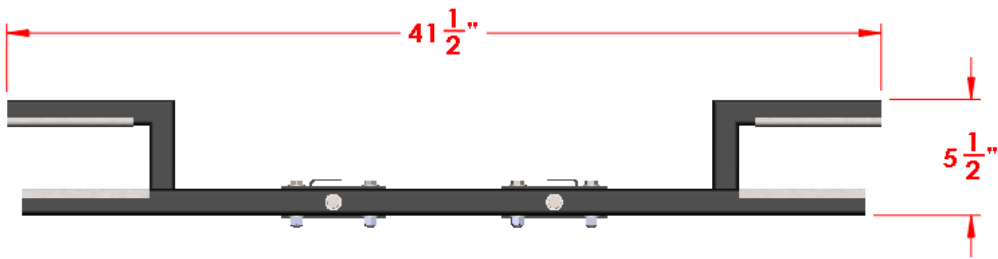
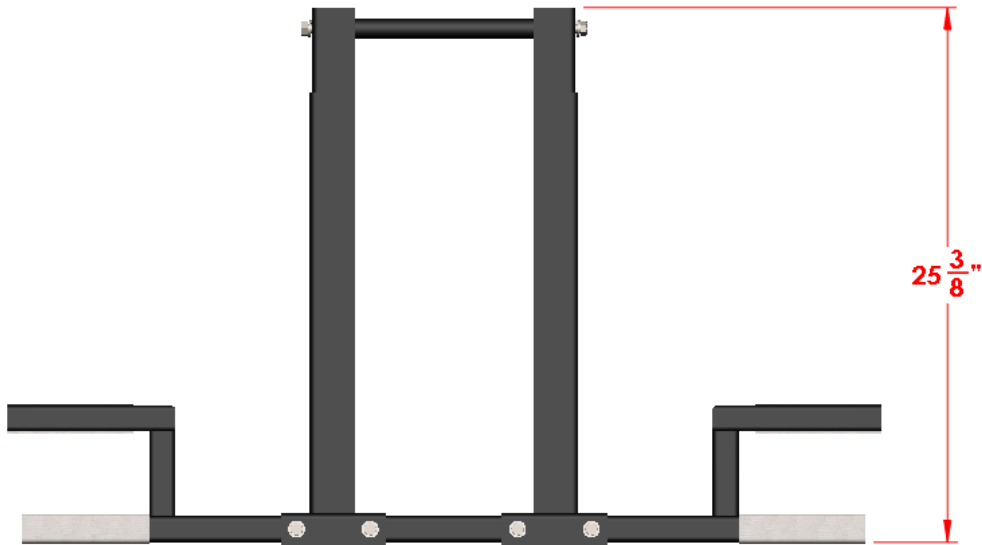
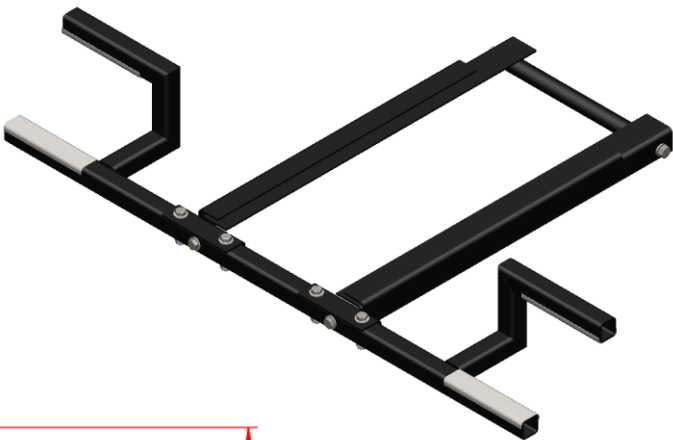

Parts

PART NUMBER	DESCRIPTION	QTY.
*	7/16-14 x 1 HEX BOLT	2
*	3/8-16 x 2 HEX BOLT	6
*	3/8-16 NYLON INSERT HEX NUT	6
*	7/16 SPLIT LOCK WASHER	2
*	2"x 6" GREY NON-SKID TAPE	4
*	1 1/4 x 1 1/4 PLASTIC END CAP (blk)	4
LK4051-01	WELDMENT 1	1
LK4051-02	WELDMENT 2	1
LK4051-03	WELDMENT 3	1
LK4051-04	WELDMENT 4	1

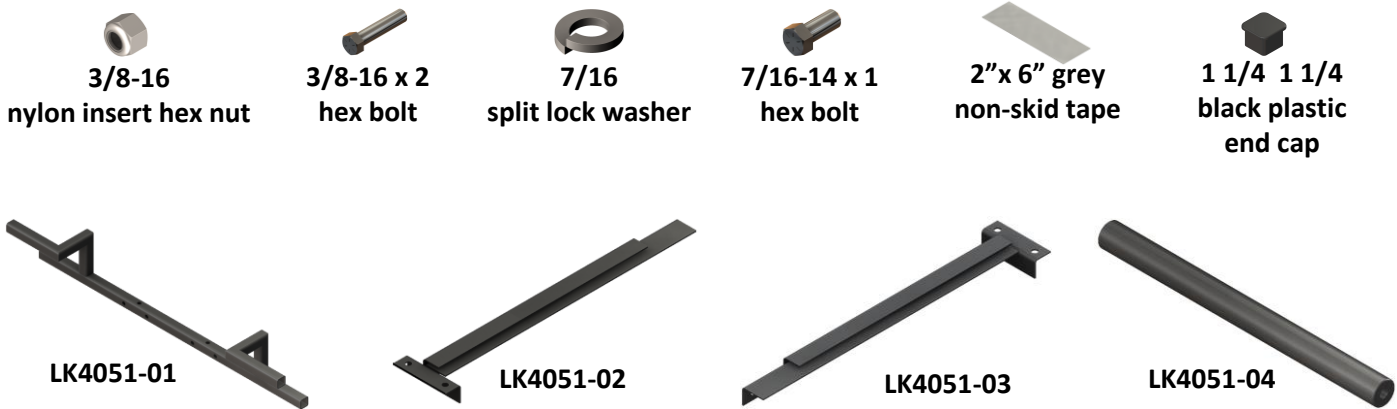

Assembly

STEP 1

Attach LK4051-02 and LK4051-03 to LK4051-01 as shown, using (4) 3/8-16 x 2 bolts and (4) 3/8-16 nylon insert lock nuts. **For ease of assembly, it is important to attach these bolts first.** Hand tighten nuts.

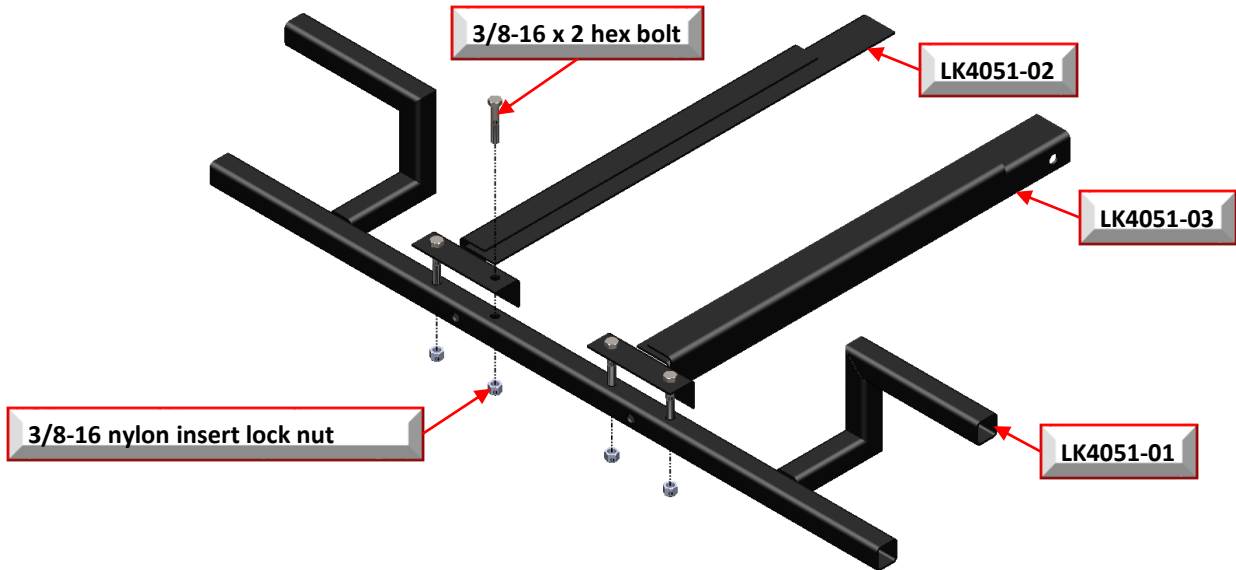

Assembly

STEP 2

Attach LK4051-02 and LK4051-03 to LK4051-01 as shown, using (2) 3/8-16 x 2 bolts and (2) 3/8-16 nylon insert lock nuts. Hand tighten nuts.

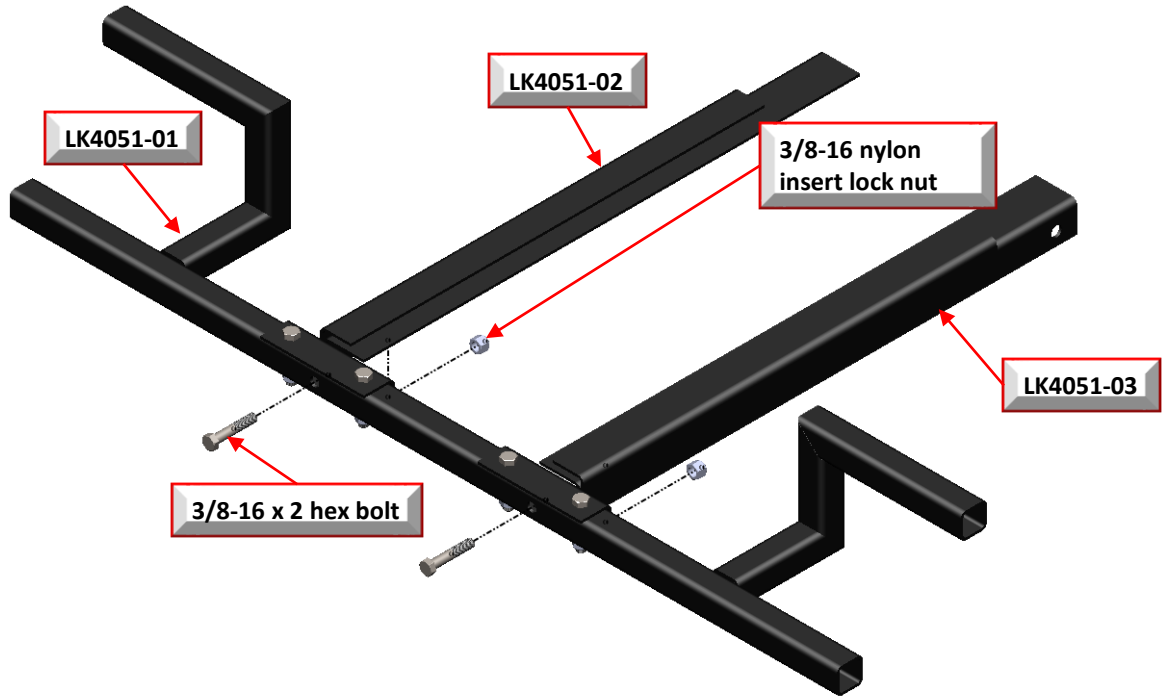

STEP 3

Attach LK4051-02 and LK4051-03 to LK4051-01 as shown, using (2) 7/16-14 x 1 hex bolts and (2) 7/16 split lock washers. **Securely tighten all fasteners.**

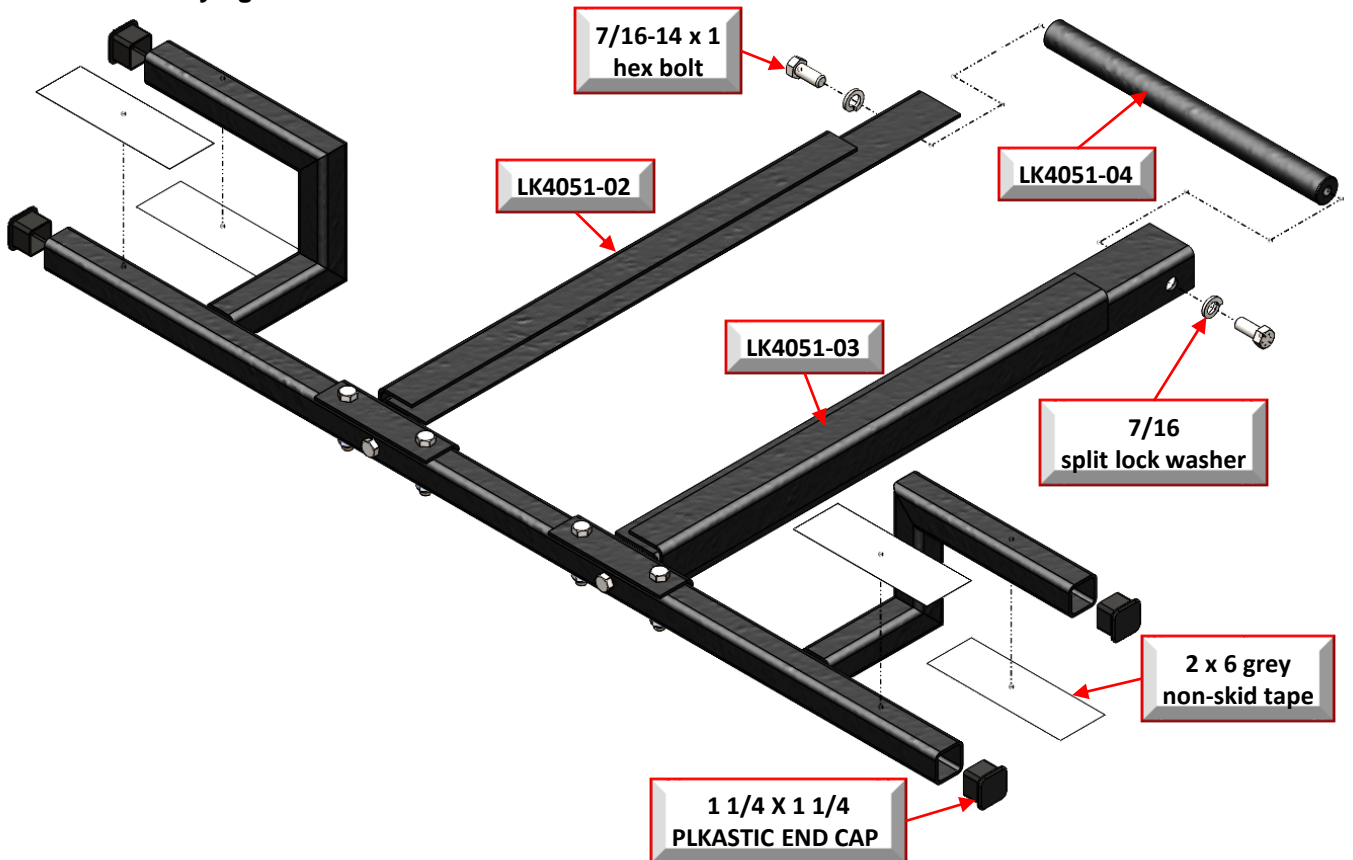

Operation

